

BALL VALVES

0644EN September 2017

VALVE FOR WATER FOR HEATING/COOLING SYSTEMS
AND NOT DANGEROUS GAS
FULL PORT - R789 SERIES



GIACOMINI
WATER E-MOTION



R789

Description

Angle ball valve, with female-tail piece male threaded connections.
Full port.

Versions and product codes

Product code	Connections	Finishing	Handle type	Handle color
R789X003	1/2"F (ISO 228) x 1/2"M (ISO 228)	Chrome plated brass	T-handle	Red
R789X005	3/4"F (ISO 228) x 3/4"M (ISO 228)	Chrome plated brass	T-handle	Red
R789X007	1"F (ISO 228) x 1"M (ISO 228)	Chrome plated brass	T-handle	Red

Technical data

Main features and materials

- Suitable for water for heating/cooling systems and not dangerous gas
- Full port
- Valve made of UNI EN 12165 CW617N chrome plated brass
- Stem with double O-Ring
- Nut with anti-corrosion coating, with guarantee seal and hologram
- Aluminium T-handle, red painted

Field of applications

- Temperature range: -20÷120 °C (-20 °C with 50 % glycol solutions)
- Max. working pressure at 20 °C with water and not dangerous gas: 1,6 MPa (16 bar)

Dimensions and Kv

Product code	DN	A [mm]	I [mm]	B [mm]	J [mm]	C [mm]	H [mm]	H' [mm]	Kv
R789X003	15	79	18	71	33	63	26	30	4,8
R789X005	20	89	21	82	39	73	32	38	8,0
R789X007	25	100	25	94	46	73	41	46	21,3

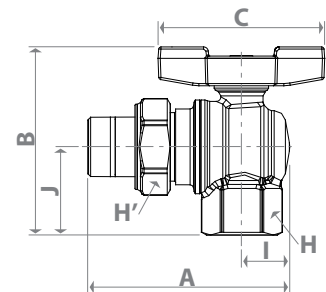

Product specifications

R789

Angle ball valve, with female-tail piece male threaded connections. Suitable for water for heating/cooling systems and not dangerous gas. Valve made of UNI EN 12165 CW617N chrome plated brass. Full port. Aluminium T-handle, red painted. Stem with double O-Ring. Nut with anti-corrosion coating, with guarantee seal and hologram. Temperature range: -20÷120 °C (-20 °C with 50 % glycol solutions). Max. working pressure at 20 °C with water and not dangerous gas: 1,6 MPa (16 bar).

BALL VALVES

0644EN September 2017

VALVE FOR WATER FOR HEATING/COOLING SYSTEMS
AND NOT DANGEROUS GAS
FULL PORT - R789 SERIES



GIACOMINI
WATER E-MOTION

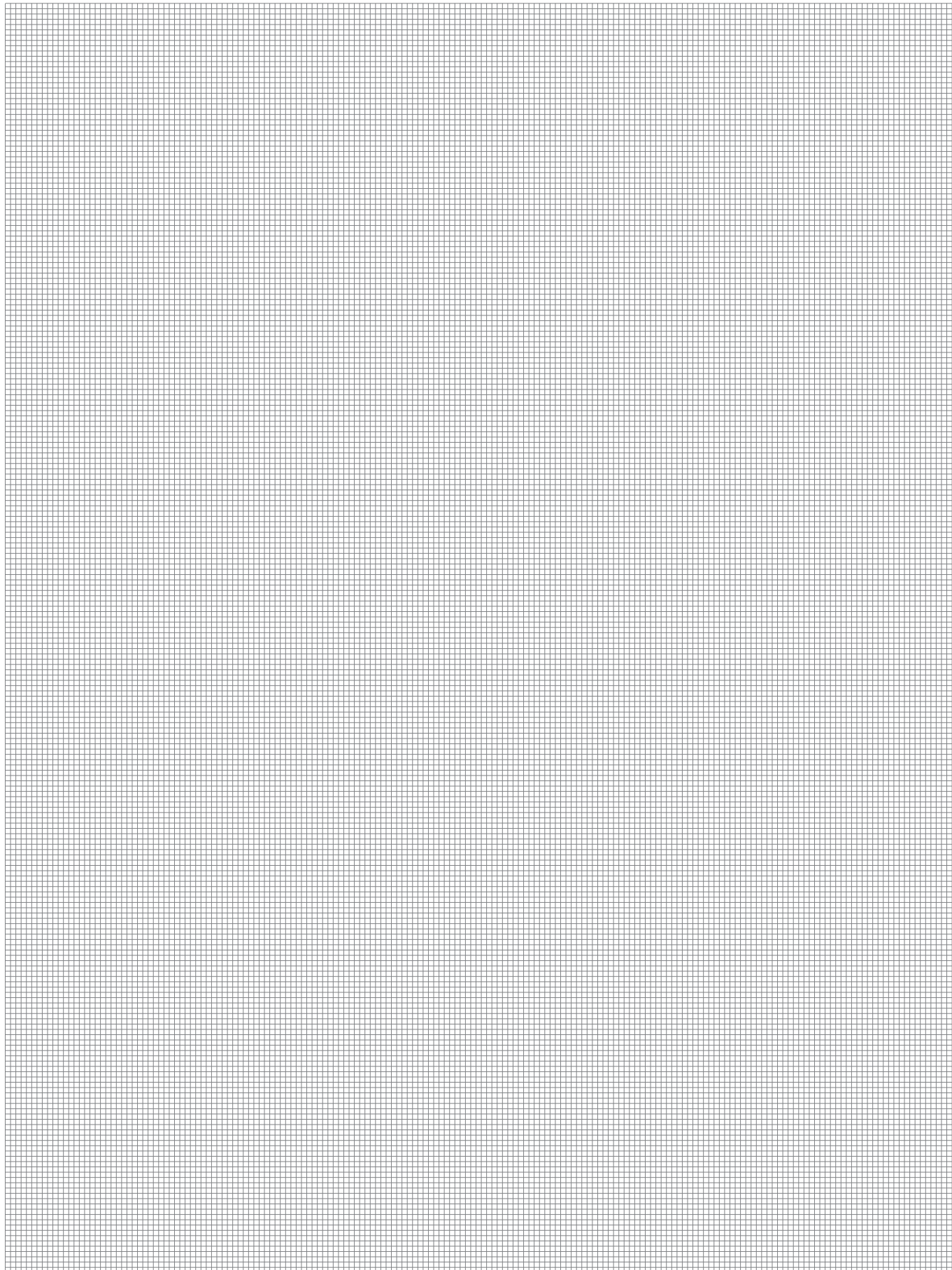

Additional information

For more information, go to www.giacomini.com or contact our technical assistance service: ☎ +39 0322 923372 📠 +39 0322 923255 ✉ consulenza.prodotti@giacomini.com
This document provides only general indications. Giacomini S.p.A. may change at any time, without notice and for technical or commercial reasons, the items included herewith.
The information included in this technical sheet do not exempt the user from strictly complying with the rules and good practice standards in force.
Giacomini S.p.A. Via per Alzo, 39 - 28017 San Maurizio d'Opaglio (NO) Italy