

BALL VALVES

0609EN September 2017

VALVE FOR WATER FOR HEATING/COOLING SYSTEMS
AND NOT DANGEROUS GAS
STANDARD PORT - R254P SERIES

 **GIACOMINI**
WATER E-MOTION



R254P

Description

Ball valve, with male-female threaded connections with nut and gasket, specific for meters connection.
Standard port.

Versions and product codes

Product code	Connections	Finishing	Handle type	Handle color	Notes
R254PX004	3/4"M (ISO 228) x Nut 3/4"F (ISO 228)	Chrome plated brass	T-handle	Red	For meter connection
R254PY003	1/2"M (ISO 228) x Nut 3/4"F (ISO 228)	Brass	T-handle	Red	For meter connection
R254PY004	3/4"M (ISO 228) x Nut 3/4"F (ISO 228)	Brass	T-handle	Red	For meter connection

Technical data

Main features and materials

- Suitable for water for heating/cooling systems and not dangerous gas
- Standard port
- Valve made of UNI EN 12165 CW617N rough or chrome plated brass
- Stem with double O-Ring
- Nut with anti-corrosion coating, with guarantee seal and hologram
- Aluminium T-handle, red painted

Field of applications

- Min. working temperature: -20 °C with 50 % glycol solutions
- Max. working temperature with dry saturated steam: 185 °C with 1,05 MPa (10,5 bar)
- Max. working pressure at 20 °C with water and not dangerous gas: 4,2 MPa (42 bar)

Dimensions and Kv

Product code	DN	A [mm]	I [mm]	B [mm]	J [mm]	C [mm]	H [mm]	H' [mm]	Kv
R254PX004	14	75	35	54	18	63	27	30	10,2
R254PY003	14	71	29	54	18	63	22	30	10,2
R254PY004	14	75	35	54	18	63	27	30	10,2

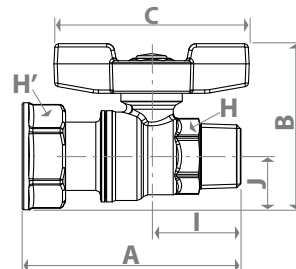

Product specifications

R254P

Ball valve, with male-female threaded connections with nut and gasket, specific for meters connection. Suitable for water for heating/cooling systems and not dangerous gas. Valve made of UNI EN 12165 CW617N rough or chrome plated brass. Standard port. Aluminium T-handle, red painted. Stem with double O-Ring. Nut with anti-corrosion coating, with guarantee seal and hologram. Min. working temperature: -20 °C with 50 % glycol solutions. Max. working temperature with dry saturated steam: 185 °C with 1,05 MPa (10,5 bar). Max. working pressure at 20 °C with water and not dangerous gas: 4,2 MPa (42 bar).

BALL VALVES

0609EN September 2017

VALVE FOR WATER FOR HEATING/COOLING SYSTEMS
AND NOT DANGEROUS GAS
STANDARD PORT - R254P SERIES



GIACOMINI
WATER E-MOTION

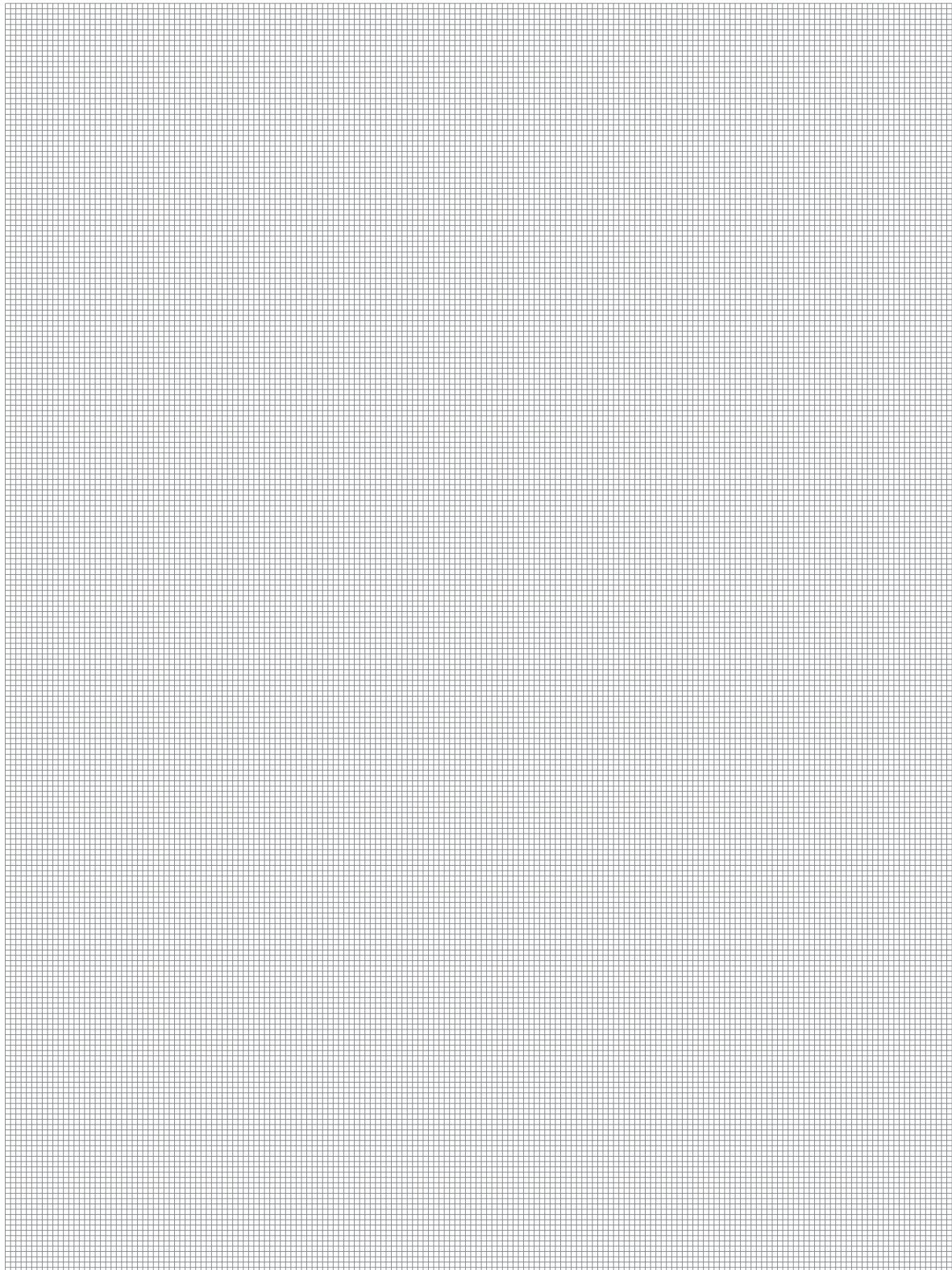

Additional information

For more information, go to www.giacomini.com or contact our technical assistance service: ☎ +39 0322 923372 📠 +39 0322 923255 ✉ consulenza.prodotti@giacomini.com
This document provides only general indications. Giacomini S.p.A. may change at any time, without notice and for technical or commercial reasons, the items included herewith.
The information included in this technical sheet do not exempt the user from strictly complying with the rules and good practice standards in force.
Giacomini S.p.A. Via per Alzo, 39 - 28017 San Maurizio d'Opaglio (NO) Italy