

BALL VALVES

0599EN September 2017

VALVE FOR WATER FOR HEATING/COOLING SYSTEMS
AND NOT DANGEROUS GAS
STANDARD PORT - R251P SERIES

GIACOMINI
WATER E-MOTION



Description

Ball valve, with female-female threaded connections with nut and gasket, specific for meters connection.
Standard port.

Versions and product codes

Product code	Connections	Finishing	Handle type	Handle color	Notes
R251PX002	1/2"F (ISO 228) x Nut 1/2"F (ISO 228)	Chrome plated brass	T-handle	Red	For meter connection
R251PX003	1/2"F (ISO 228) x Nut 3/4"F (ISO 228)	Chrome plated brass	T-handle	Red	For meter connection
R251PX004	3/4"F (ISO 228) x Nut 3/4"F (ISO 228)	Chrome plated brass	T-handle	Red	For meter connection
R251PX005	3/4"F (ISO 228) x Nut 1"F (ISO 228)	Chrome plated brass	T-handle	Red	For meter connection
R251PX006	1"F (ISO 228) x Nut 1"F (ISO 228)	Chrome plated brass	T-handle	Red	For meter connection
R251PY003	1/2"F (ISO 228) x Nut 3/4"F (ISO 228)	Brass	T-handle	Red	For meter connection
R251PY004	3/4"F (ISO 228) x Nut 3/4"F (ISO 228)	Brass	T-handle	Red	For meter connection
R251PY005	3/4"F (ISO 228) x Nut 1"F (ISO 228)	Brass	T-handle	Red	For meter connection
R251PY006	1"F (ISO 228) x Nut 1"F (ISO 228)	Brass	T-handle	Red	For meter connection
R251PY045	3/4"F (ISO 228) x Nut 1"F (ISO 228)	Brass	T-handle	Blue	For meter connection
R251PY046	1"F (ISO 228) x Nut 1"F (ISO 228)	Brass	T-handle	Blue	For meter connection

Technical data

Main features and materials

- Suitable for water for heating/cooling systems and not dangerous gas
- Standard port
- Valve made of UNI EN 12165 CW617N rough or chrome plated brass
- Stem with double O-Ring
- Nut with anti-corrosion coating, with guarantee seal and hologram
- Aluminium T-handle, red or blue painted

Field of applications

- Min. working temperature: -20 °C with 50 % glycol solutions
- Max. working temperature with dry saturated steam: 185 °C with 1,05 MPa (10,5 bar)
- Max. working pressure at 20 °C with water and not dangerous gas: 4,2 MPa (42 bar) for 1/2"F - 3/4"F; 3,5 MPa (35 bar) for 1"F

Dimensions and Kv

Product code	DN	A [mm]	I [mm]	B [mm]	J [mm]	C [mm]	H [mm]	H' [mm]	Kv
R251PX002	14	68	27	51	15	63	25	24	10,2
R251PX003	14	76	27	54	18	63	25	30	10,2
R251PX004	14	76	28	54	18	63	32	30	10,2
R251PX005	18	85	31	63	21	73	32	37	18,5
R251PX006	22	105	38	69	23	73	40	37	36,3
R251PY003	14	76	27	54	18	63	25	30	10,2
R251PY004	14	76	28	54	18	63	32	30	10,2
R251PY005	18	85	31	63	21	73	32	37	18,5
R251PY006	22	103	38	69	23	73	40	37	36,3
R251PY045	18	85	31	63	21	73	32	37	18,5
R251PY046	22	105	38	69	23	73	40	37	36,3

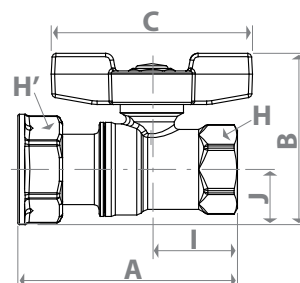

Product specifications

R251P

Ball valve, with female-female threaded connections with nut and gasket, specific for meters connection. Suitable for water for heating/cooling systems and not dangerous gas. Valve made of UNI EN 12165 CW617N rough or chrome plated brass. Standard port. Aluminium T-handle, red or blue painted. Stem with double O-Ring. Nut with anti-corrosion coating, with guarantee seal and hologram. Min. working temperature: -20 °C with 50 % glycol solutions. Max. working temperature with dry saturated steam: 185 °C with 1,05 MPa (10,5 bar). Max. working pressure at 20 °C with water and not dangerous gas: 4,2 MPa (42 bar) for 1/2"F - 3/4"F; 3,5 MPa (35 bar) for 1"F.

BALL VALVES

0599EN September 2017

VALVE FOR WATER FOR HEATING/COOLING SYSTEMS
AND NOT DANGEROUS GAS
STANDARD PORT - R251P SERIES



GIACOMINI
WATER E-MOTION

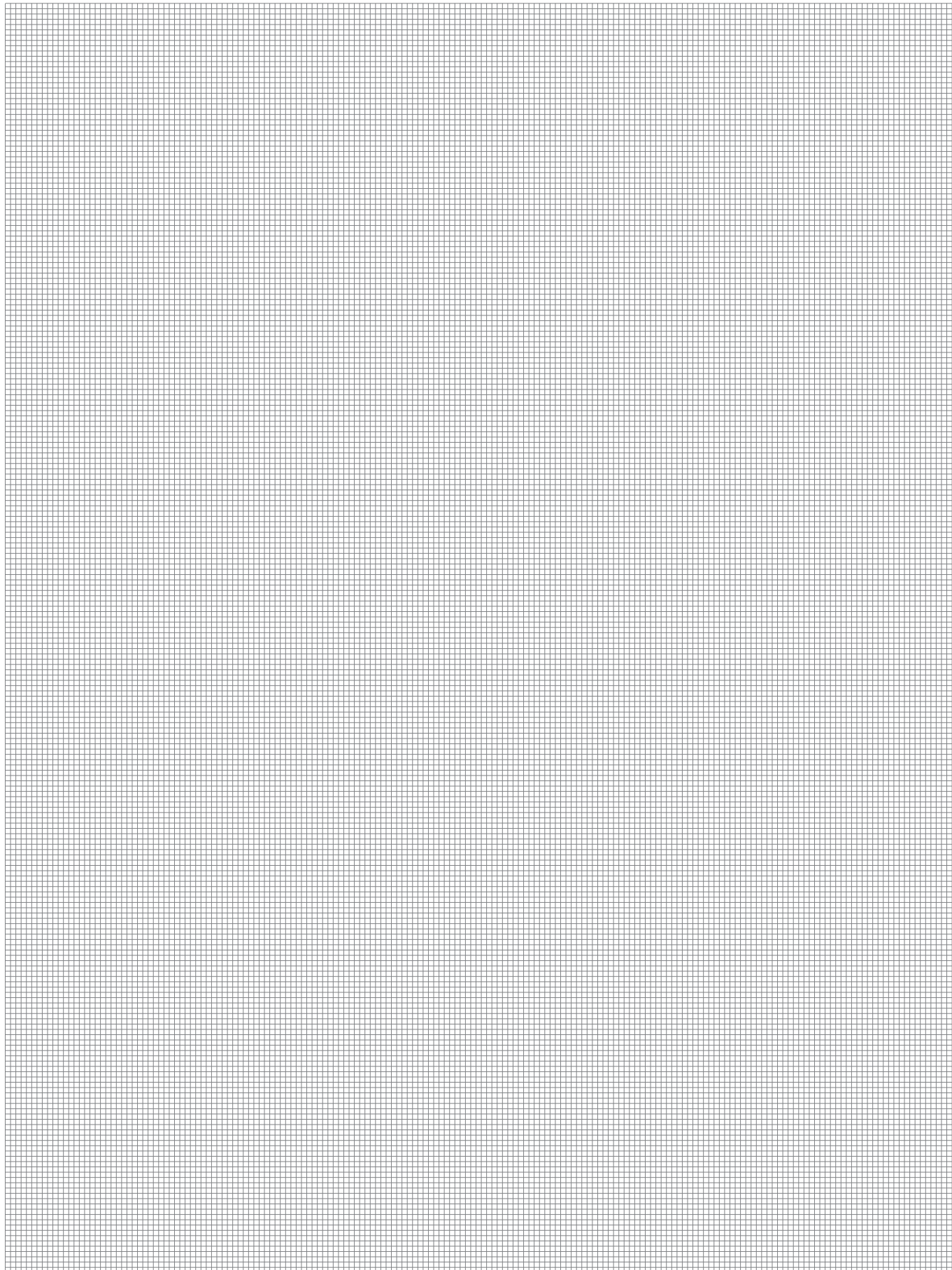

Additional information

For more information, go to www.giacomini.com or contact our technical assistance service: ☎ +39 0322 923372 📞 +39 0322 923255 ✉ consulenza.prodotti@giacomini.com
This document provides only general indications. Giacomini S.p.A. may change at any time, without notice and for technical or commercial reasons, the items included herewith.
The information included in this technical sheet do not exempt the user from strictly complying with the rules and good practice standards in force.
Giacomini S.p.A. Via per Alzo, 39 - 28017 San Maurizio d'Opaglio (NO) Italy