



Description

Domestic water meters for boiler room, series **GE552-3**, with male threaded connections, multiple jet, dry dial and direct reading on five numbered drums, equipped with pulse output via REED.

Two versions: cold domestic water (30 °C) and hot domestic water (90 °C).

Versions and product codes

Product code	Permanent flow rate [m³/h]	Nominal diameter [mm - inch]	Threaded connections [inch]	Centre distance [mm]	Type of domestic water
GE552Y161	6,3	DN25 - 1"	1 1/4"	260	Cold
GE552Y162	10	DN32 - 1 1/4"	1 1/2"	260	Cold
GE552Y163	16	DN40 - 1 1/2"	2"	300	Cold
GE552Y164	25	DN50 - 2"	2 1/2"	300	Cold
GE552Y166	6,3	DN25 - 1"	1 1/4"	260	Hot
GE552Y167	10	DN32 - 1 1/4"	1 1/2"	260	Hot
GE552Y168	16	DN40 - 1 1/2"	2"	300	Hot
GE552Y169	25	DN50 - 2"	2 1/2"	300	Hot

Technical data

- Max. working temperature:
30 °C for Domestic cold water meter
90 °C for Domestic hot water meter
- Max. working pressure: 16 bar

REED characteristics

- 1 impulse = 10 litres
- Maximum voltage: 24 V
- Minimum voltage: 0,02 V
- Max. interrupting current: 0,5 A
- Max. supporting current: 1,2 A
- Max. capacity: 10 W / VA

Losses of pressure

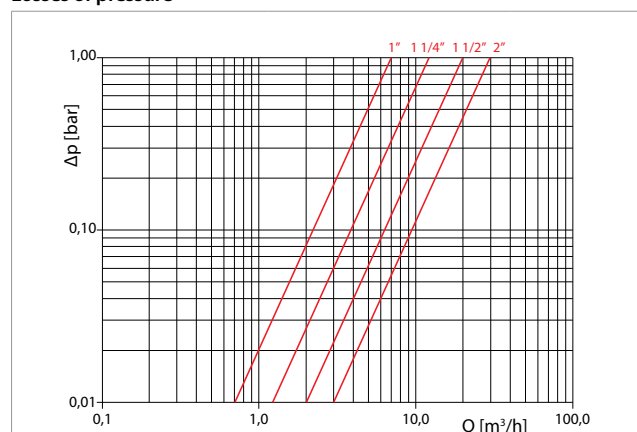

Nominal diameter [mm - inch]	Threaded connections [inch]	Kv
DN25 - 1"	1 1/4"	7
DN32 - 1 1/4"	1 1/2"	12
DN40 - 1 1/2"	2"	20
DN50 - 2"	2 1/2"	30

Metrological characteristics

Nominal diameter [mm - inch]	DN25 - 1"	DN32 - 1 1/4"	DN40 - 1 1/2"	DN50 - 2"
Threaded connections [inch]	1 1/4"	1 1/2"	2"	2 1/2"
Overload flow rate Q4 [m³/h]	8	12	20	31
Permanent flow rate Q3 [m³/h]	6,3	10	16	25
Transition flow rate Q2 [l/h]	202	320	512	800
Minimum flow rate Q1 [l/h]	126	200	320	500
Sensitivity [l/h]	17	27	46	75
Minimum reading [l]	0,05			
Maximum reading [m³]	100.000		1.000.000	
Accuracy class*	2			



*NB:
Q2/Q1 = 1,6
Q3/Q1 = 50 (horizontal installation)

Dimensions

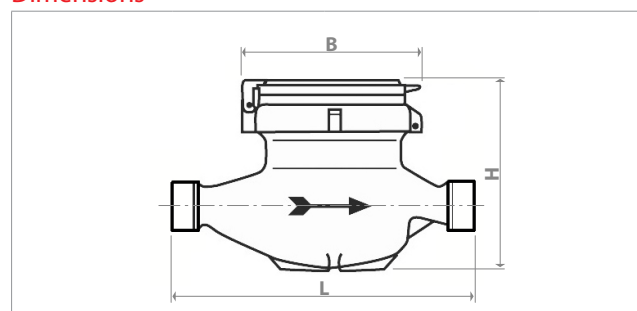

Nominal diameter [mm - inch]	Threaded connections [inch]	L [mm]	H [mm]	B [mm]
DN25 - 1"	1 1/4"	260	117	104
DN32 - 1 1/4"	1 1/2"	260	117	104
DN40 - 1 1/2"	2"	300	153	126
DN50 - 2"	2 1/2"	300	172	160



Compliance with MID Directive

If used for commercial applications, the energy meters are classified as measuring instruments subject to the rules of legal metrology. The GE552-3 Domestic water meters for boiler room comply with the requisites of Directive 2004/22/EC on measuring instruments (MID - Measurement Instrument Directive), implemented in Italy by Legislative Decree 2 February 2007, no. 22 (Official Gazette no. 64 of 17 March 2007). The certificate of conformity was issued by the PTB Metrology Institute (Physikalisch-Technische Bundesanstalt).

**NB:**

the supplementary metrological marking is displayed on the front of each device, next to the EC mark. It consists of an "M" plus the last two digits of the year of marking, surrounded by a rectangle.

Remote reading enabling through energy meters

Remote access to the Domestic water meters via the M-Bus is possible, using energy meters. For the connections, refer to the technical datasheets of the thermal energy meters.

Product specifications

GE552-3

Domestic water meters for boiler room, with threaded male connections, multiple jet, dry dial and direct reading on five numbered drums. Two versions - cold Domestic water (30 °C) and hot Domestic water (90 °C). Max. working pressure 16 bar. Water meter equipped with pulse output via REED. Complying with Directive 2004/22/EC (MID).

Additional information

For more information, go to www.giacomini.com or contact our technical assistance service: ☎ +39 0322 923372 📠 +39 0322 923255 ✉ consulenza.prodotti@giacomini.com
This document provides only general indications. Giacomini S.p.A. may change at any time, without notice and for technical or commercial reasons, the items included herewith.
The information included in this technical sheet do not exempt the user from strictly complying with the rules and good practice standards in force.
Giacomini S.p.A. Via per Alzo, 39 - 28017 San Maurizio d'Opaglio (NO) Italy