

ISTRUZIONI VALVOLE DI ZONA R276B

R276B ZONE VALVES INSTRUCTION

Gennaio 2015 - January 2015 047U54938



GIACOMINI
WATER E-MOTION



IT - Codici EN - Product codes

Codice Product codes	Attacchi Connections	DN	Alimentazione elettrica dell'attuatore Actuator supply
R276BX006	1 1/4"	32	230 V (K272Y101)
R276BX026			24 V (K272Y102)
R276BX007	1 1/2"	40	230 V (K272Y101)
R276BX027			24 V (K272Y102)
R276BX008	2"	50	230 V (K272Y101)
R276BX028			24 V (K272Y102)

IT - Dati tecnici valvola EN - Valve technical data

Campo di temperatura di esercizio (valvola)	Working temperature range (valve)	-20÷170 °C
Campo di temperatura di esercizio (valvola + attuatore)	Working temperature range (valve + actuator)	-5÷110 °C
Pressione nominale (PN)	Nominal pressure (PN)	40 bar
Massima pressione differenziale	Max differential pressure	16 bar
Filettatura	Thread	Gas ISO 228
Attacco attuatore	Actuator connection	ISO 5211
Fluidi compatibili	Compatible fluids	acqua, acqua e glicole (max.50%) water, water and glycol (max.50%)

IT - Materiali EN - Materials

Corpo, sfera, asta di comando	Body, sphere, stem	Ottone CW617N Brass CW617N
Guarnizioni	Washers	FPM PTFE carbographite filled
Coibentazione	Insulation	Polietilene espanso reticolato Cross-linked polyethylene foam

IT - Funzionamento EN - Operation

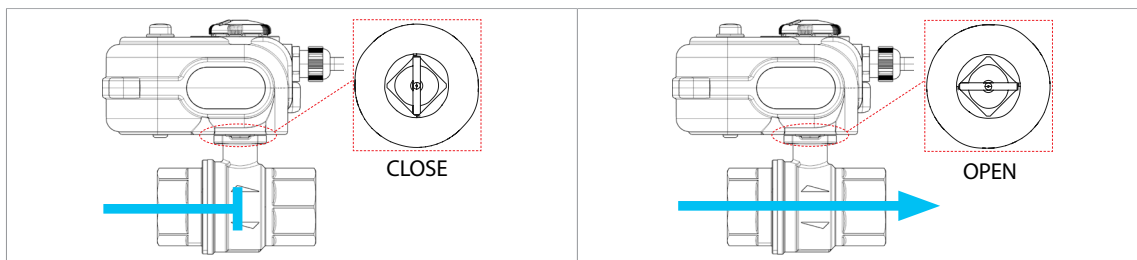

IT - Dimensioni EN - Dimensions

Valvola - Valve						Valvola e attuatore - Valve and actuator						Coibentazione - Insulation						
G (DN)	Attacco flangia Flange connection	A [mm]	I [mm]	B [mm]	J [mm]	S [mm]	H [mm]	P [mm]	B1 [mm]	J1 [mm]	A1 [mm]	S1 [mm]	X [mm]	Y [mm]	Ø	A2 [mm]	B2 [mm]	S2 [mm]
1 1/4" (DN32)	F03	110	52	83	50	65	50	9	163	130	157	76	36	9	M5	125	90	80
1 1/2" (DN40)	F05	120	59	102	62	80	55	10	182	142	157	76	50	11	M6	130	110	95
2" (DN50)	F05	140	68	117	69	96	70	10	197	149	157	76	50	11	M6	150	120	110

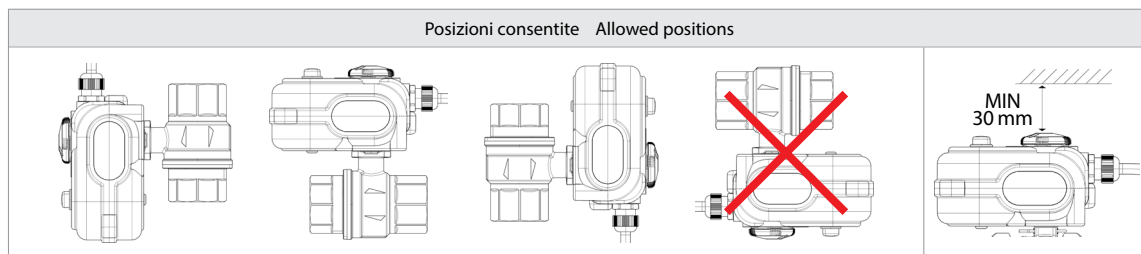

Installazione con kit ISO5211 F03/F05 - Installation with ISO5211 F03/F05 kit

KIT ISO 5211

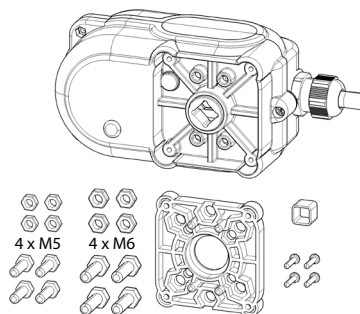

1

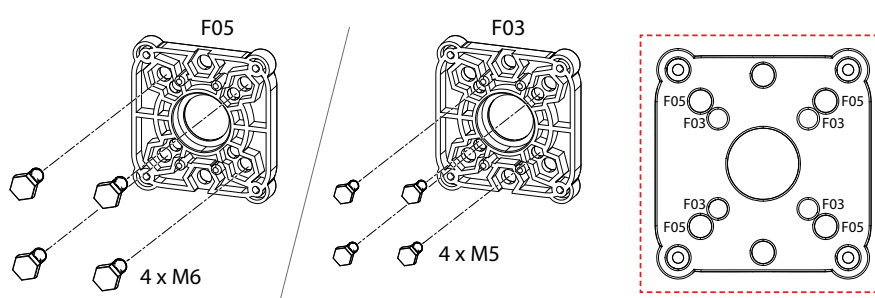

2

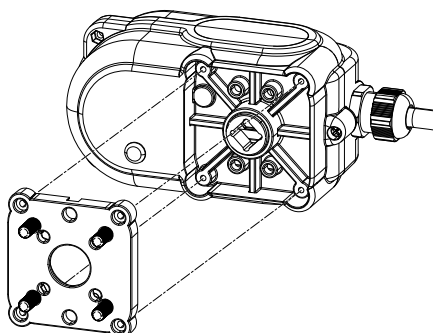

3

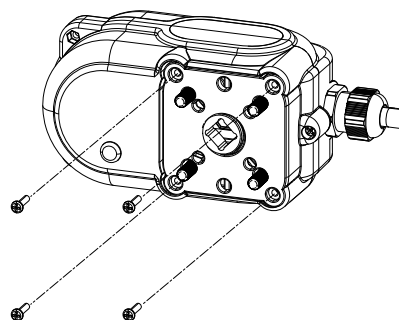

4

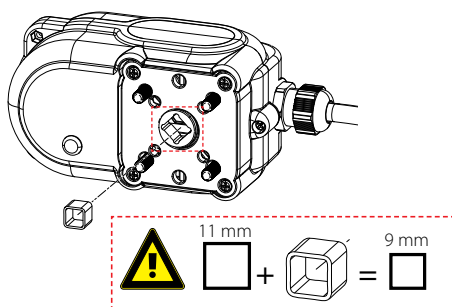

5

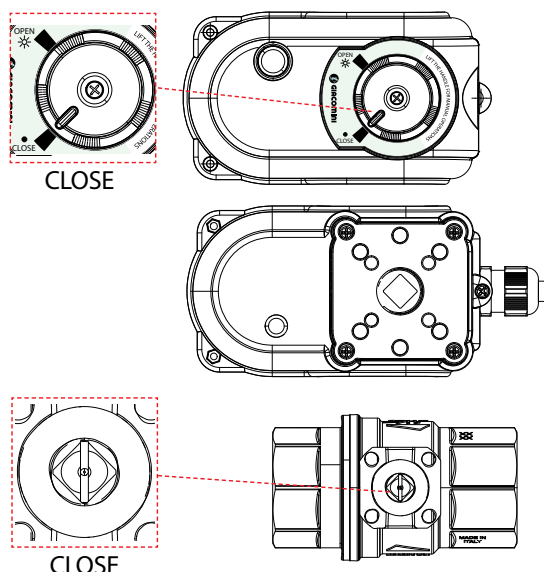

6

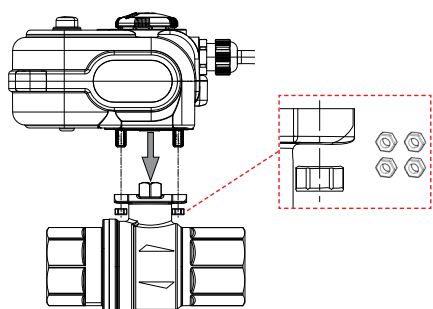

Additional information

For additional information please check the website www.giacomini.com or contact the technical service: ☎ +39 0322 923372 📠 +39 0322 923255 ✉ consulenza.prodotti@giacomini.com
This pamphlet is merely for information purposes. Giacomini S.p.A. retains the right to make modifications for technical or commercial reasons, without prior notice, to the items described in this pamphlet. The information described in this technical pamphlet does not exempt the user from following carefully the existing regulations and norms on good workmanship. Giacomini S.p.A. Via per Alzo, 39 - 28017 San Maurizio d'Ogaglio (NO) Italy