



**R387L**

**R388L**

**Description**

R387L straight and R388L angled twin-pipe valves have been designed for panel radiators with integrated control, with 3/4"E connection and 50 mm center distance. Panel radiators with 1/2"F connection can also be connected using a special adapter.

R387L and R388L valves are equipped with internal lockshield valves on the two connections by which the flow can be intercepted isolating the panel radiators. The lockshield valves also enable to balance the circuits with an Allen key by varying the number of turns to open them (we recommend turning only one lockshield valve, leaving the other completely open).

**Versions and product codes**

Series	Product code	Connections "Panel radiator x Pipe"	Version
R387L	R387LX001	3/4"F x base 18	straight
	R387LX011	1/2"M x base 18	
	R387LX002	3/4"F x 3/4"E	
	R387LX012	1/2"M x 3/4"E	
R388L	R388LX001	3/4"F x base 18	angled
	R388LX011	1/2"M x base 18	
	R388LX002	3/4"F x 3/4"E	
	R388LX012	1/2"M x 3/4"E	



**Notes.**  
Codes for 3/4"F panel radiators include n. 2 Eurocono inserts R483Y011.  
Codes for 1/2"M panel radiators include n. 2 adapters R483Y002 (1/2"M x 3/4"M).

**Technical data**

- Temperature range: 5÷110 °C
- Max. working pressure: 10 bar
- Heating element flow rate 100 %
- Connections center distance: 50 mm
- Balancing lockshield valves adjustable with 6 mm hexagonal Allen key
- Panel radiator connections with EPDM self-sealing gasket
- System connections with 3/4"E adapter or base 18
- Non-preferential delivery and return connections

**Materials**

- Valve body and nuts: brass UNI EN 12165 - CW617N with surface nickel-plating
- Gaskets: EPDM

**Pressure losses**

The pressure loss diagrams have been determined for the R387L straight valve and the R388L angled valve keeping one lockshield valve completely open and varying the number of turns to open the other.

To determine the total pressure loss, the loss value for the supplying pipe and the one for the radiator with integrated thermostatic control must be added to the valve pressure loss.

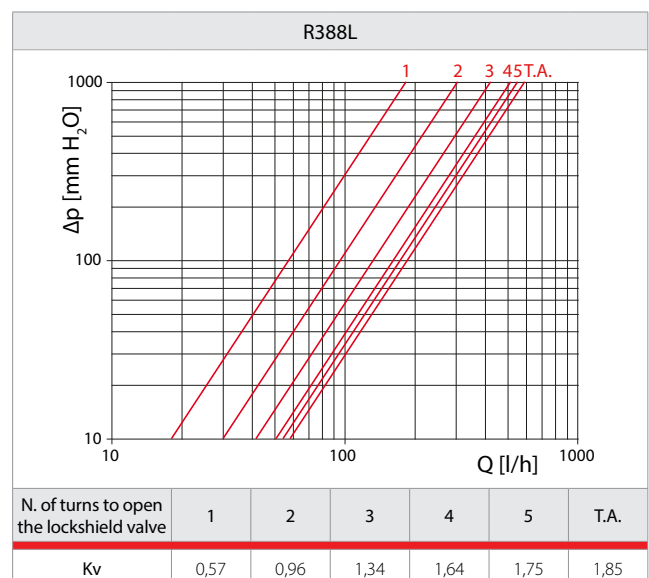
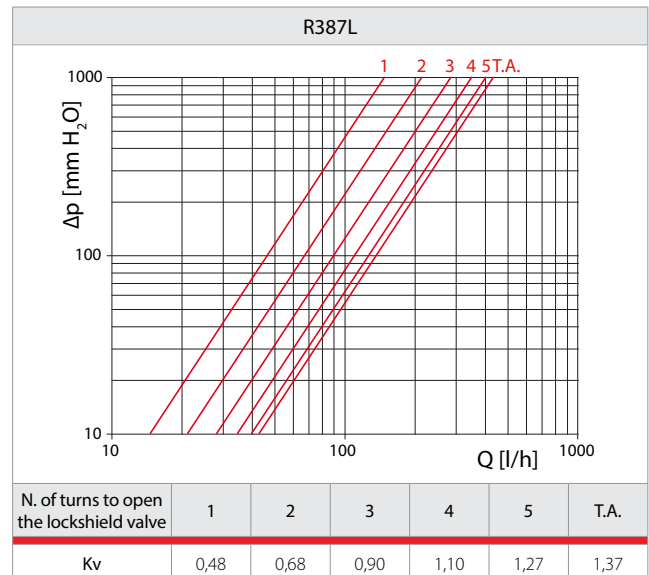



**Installation**

The twin-pipe valves R387L and R388L, are connected directly to panel radiators with 3/4"E connection, placing the included R483Y011 plastic adapter in between.

If the panel radiators have 1/2"F connections, the R483Y002 special adapter with self-sealing gasket should be screwed on the panel radiator with a 10 mm hexagonal Allen key.

After installing the adapter, connect the valve by tightening the nuts with a 30 mm hexagonal wrench.

The valves are connected to the supplying pipes with Eurocono (R178E, R179E) or base 18 (R178, R179, R179AM) adapters, according to the version.



**Product specifications**

**R387L**

Panel radiator valve with integrated thermostatic group, straight for floor-deriving pipes, nickel-plated brass. Flat seat connections with gaskets, including self-sealing adapters for 3/4"M or 1/2"F panel radiators. Center distance 50 mm. Piping connection with 3/4" Eurocono or base 18 adapters. Temperature range: 5÷110 °C. Max. working pressure: 10 bar.

**R388L**

Panel radiator valve with integrated thermostatic group, angled for wall-deriving pipes, nickel-plated brass. Flat seat connections with gaskets, including self-sealing adapters for 3/4"M or 1/2"F panel radiators. Center distance 50 mm. Piping connection with 3/4" Eurocono or base 18 adapters. Temperature range: 5÷110 °C. Max. working pressure: 10 bar.

**Dimensions**

**R387L**

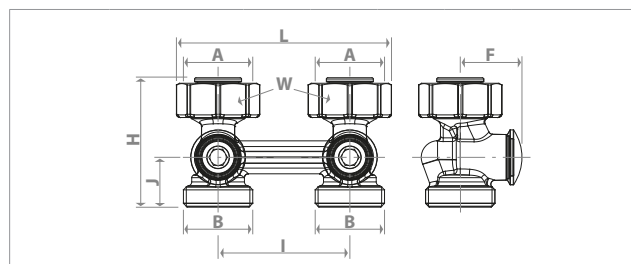

Product code	A x B	I [mm]	L [mm]	H [mm]	J [mm]	F [mm]	W [mm]
R387LX001	3/4"F x base 18	50	82	49	19	23	30
R387LX002	3/4"F x 3/4"E	50	82	49	19	23	30

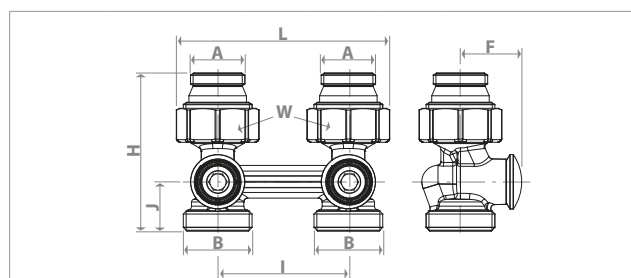

Product code	A x B	I [mm]	L [mm]	H [mm]	J [mm]	F [mm]	W [mm]
R387LX011	1/2"M x base 18	50	82	61	19	23	30
R387LX012	1/2"M x 3/4"E	50	82	61	19	23	30

**R388L**

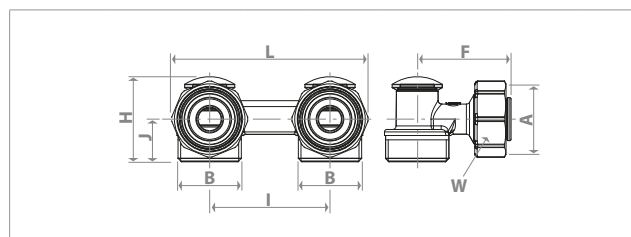

Product code	A x B	I [mm]	L [mm]	H [mm]	J [mm]	F [mm]	W [mm]
R388LX001	3/4"F x base 18	50	82	36	18	39	30
R388LX002	3/4"F x 3/4"E	50	82	36	18	39	30

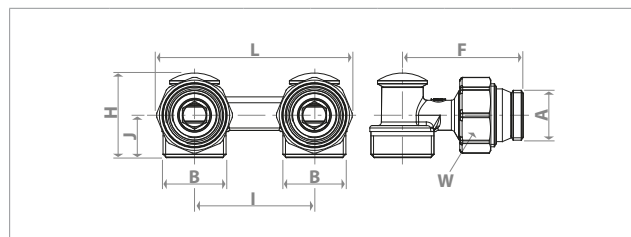

Product code	A x B	I [mm]	L [mm]	H [mm]	J [mm]	F [mm]	W [mm]
R388LX011	1/2"M x base 18	50	82	36	18	51	30
R388LX012	1/2"M x 3/4"E	50	82	36	18	51	30

**Additional information**

For additional information please check the website [www.giacomini.com](http://www.giacomini.com) or contact the technical service: ☎ +39 0322 923372 📠 +39 0322 923255 ✉ [consulenza.prodotti@giacomini.com](mailto:consulenza.prodotti@giacomini.com)  
 This pamphlet is merely for information purposes. Giacomini S.p.A. retains the right to make modifications for technical or commercial reasons, without prior notice, to the items described in this pamphlet. The information described in this technical pamphlet does not exempt the user from following carefully the existing regulations and norms on good workmanship.  
 Giacomini S.p.A. Via per Alzo, 39 - 28017 San Maurizio d'Opaglio (NO) Italy